

WKO Duct Fans

Duct fans are really useful solution in many ventilation installations because of their easy construction, easy assembly and the low costs of construction and operation. They connect the advantages of axial and radial fans because they keep the axial air flow direction with the possibility of overcome the bigger installation resistances. WKO fans operation is characterized by the low volume emitted to the environment. Duct fans are designed for use them in the intake and exhaust ventilating installations made in the industrial and general building engineering. Flowing air can be polluted with the vapors and corrosive gases and polluted with the gases within the limits which are permitted by the environment protection regulations.

PRODUCT DESCRIPTION

Series of types of fans include 6 dimensions. Fans consist in:

- casing made of plastic with the connecting spout to the ventilating installations
- highly efficient plastic centrifugal rotor with motor placed inside of the rotor

WORKING CONDITIONS

Duct fans can work in each position. Permissible temperature of removed air is 50°C

WKO-10

DIMENSIONS

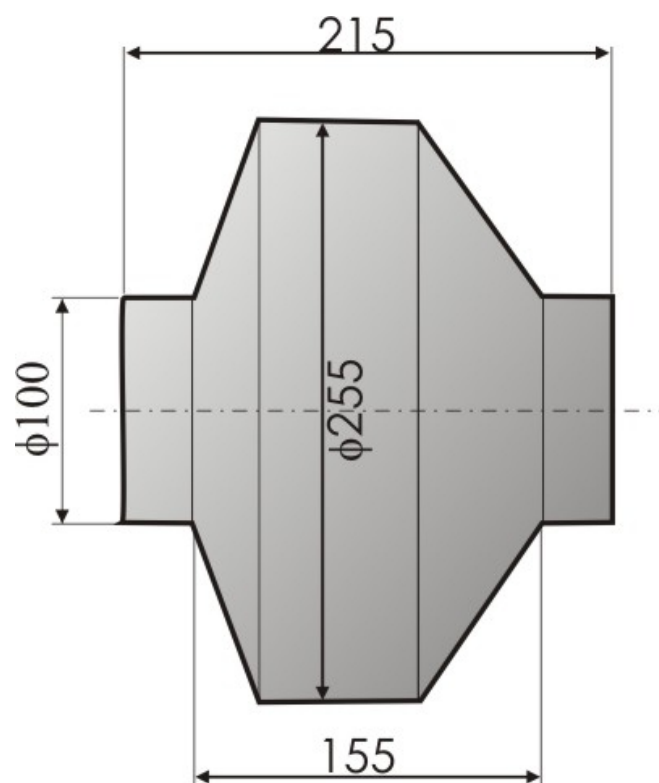

CHARACTERISTICS:



One-phase motors	
Motor type	RH19L-2EP.W6.1R
Voltage [V]	230
Motor power [kW]	0,070
Current [A]	0,29
Revolutions [rpm]	2400

WKO-12,5

DIMENSIONS



CHARACTERISTICS:



One-phase motors	
Motor type	RH19L-2EP.W6.1R
Voltage [V]	230
Motor power [kW]	0,070
Current [A]	0,29
Revolutions [rpm]	2400

WKO-16

DIMENSIONS



CHARACTERISTICS:



One-phase motors	
Motor type	RH22L-2EP.WA.1R
Voltage [V]	230
Motor power [kW]	0,100
Current [A]	0,44
Revolutions [rpm]	2500

WKO-20

DIMENSIONS



CHARACTERISTICS:



One-phase motors	
Motor type	RH22L-2EP.WC.4R
Voltage [V]	230
Motor power [kW]	0,160
Current [A]	0,71
Revolutions [rpm]	2510

WKO-25

DIMENSIONS

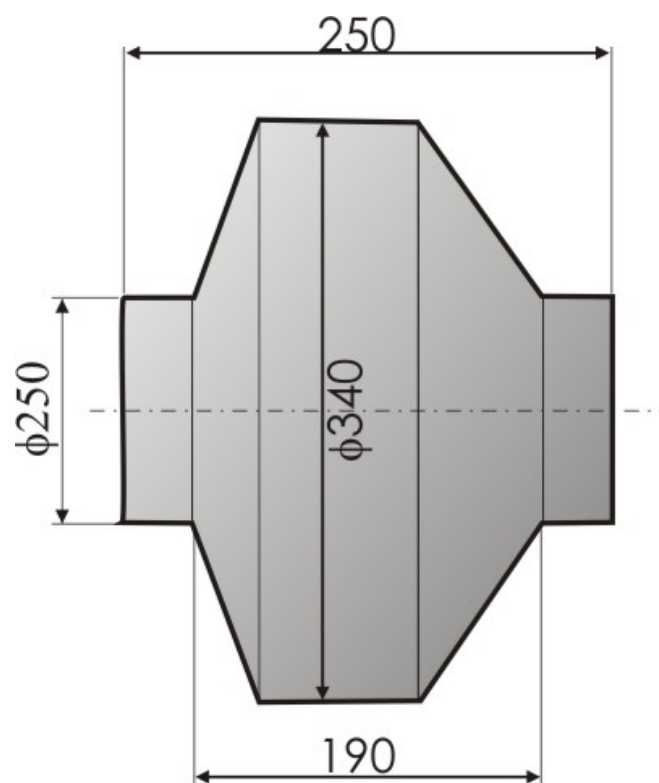

CHARACTERISTICS:

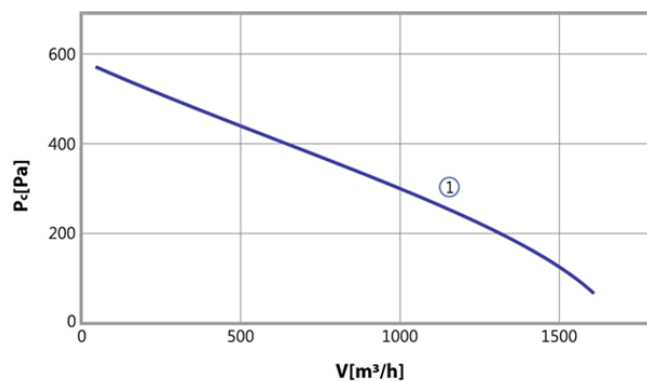

One-phase motors	
Motor type	RH25L-2EP.WD.1R
Voltage [V]	230
Motor power [kW]	0,220
Current [A]	0,93
Revolutions [rpm]	2370

WKO 31,5

DIMENSIONS

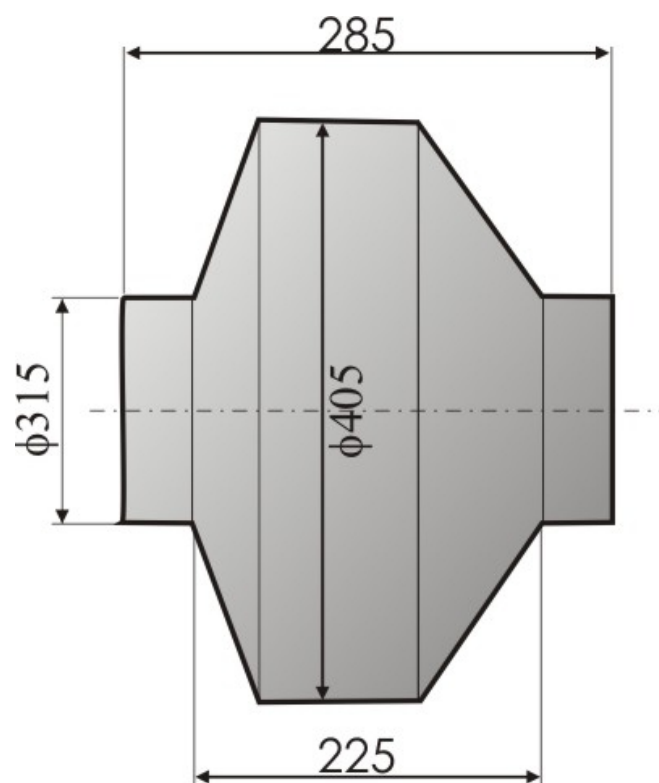

CHARACTERISTICS:



One-phase motors	
Motor type	RH28L-2EP.WD.1R
Voltage [V]	230
Motor power [kW]	0,290
Current [A]	1,24
Revolutions [rpm]	2250